

*Courses & Distances up the Frankstown Branch from the Elum to the Hy.*

N. 4 W.	116
N. 24 E.	63
North 44.	44.
	<hr/>
	223.

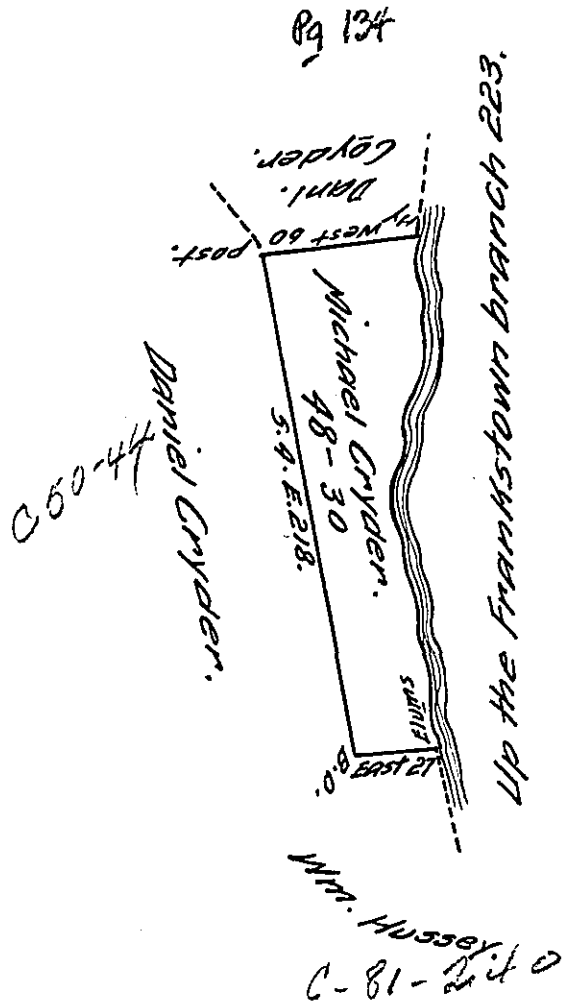

*Situate about Two Miles above the Town of Huntingdon.*

*Including Michael Cryders House & Mills in the Township & County of Huntingdon County Containing 48 Acres & 30 perches & the usual Allowance for Roads. Surveyed the 1st. Day of July, 1794. In pursuance of a Warrant to Michael Cryder Dated the 29th Day of May 1793.*

*Daniel Brodhead Esquire, S. G.*

*John Canan, D. S.*

*IN TESTIMONY that the above is a copy of the original remaining on file in the Department of Internal Affairs of Pennsylvania, made conformably to an Act of Assembly approved the 16th day of February, 1833, I have hereunto set my Hand and caused the Seal of said Department to be affixed at Harrisburg, this twenty sixth day of April 1911*

*Henry Houch*  
Secretary of Internal Affairs.